

Model Number: **STSLIM1**  
 Description: **SUPERTUB CABINET**  
 Bar Code: **9414930213392**

## Typical design

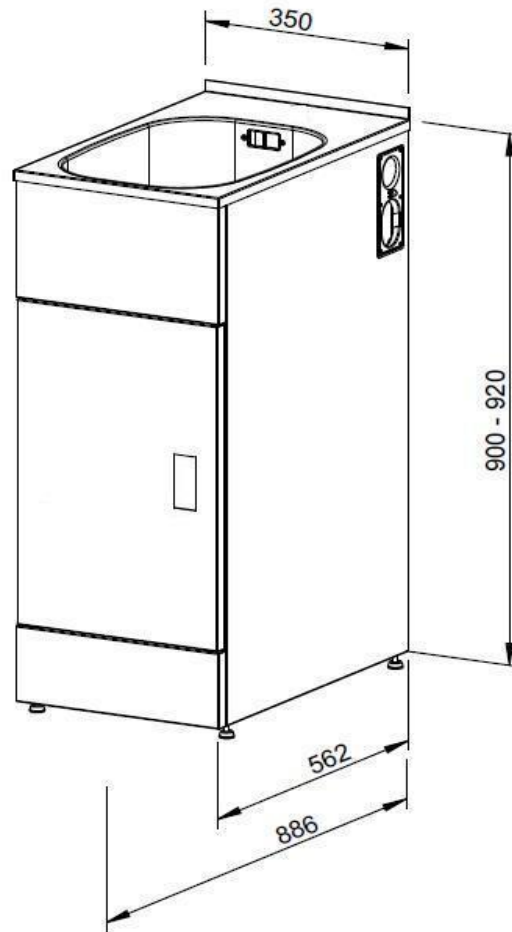

## Features and benefits

### Features

- Spacious single door
- Seamless stainless steel tub
- Powder coated galvanized steel cabinet
- Modern styling
- Side apertures for hoses
- Supporting levelling feet
- Separate waste pipe for washing machine
- Improved plumbing components

### Benefits

- Easy organization and storage in the laundry
- Left or right option
- Long lasting and easy to clean
- Corrosion resistant for long life
- Compliments leading brands of washing machines
- Finger touch control of water flow
- Ensure stability on uneven surfaces
- Allows a tap less console, giving a cleaner, more aesthetic appearance
- Allows washing machine to empty when tub is full

## Specifications

### Technical data:

- Cabinet - 0.6mm galvanized sheet metal, powder coated. 24 months warranty
- Bowl – 0.8mm polished stainless steel bowl, 17 litre capacity. 5 years warranty
- Plastic parts - ABS UV (ultra violet sun protection)

**Nett Weight:** 11.9 kg

**Carton Weight:** 15.1 kg

**Carton Dimension (mm):** 389 x 630 x 970 (w x d x h)

**Volume (m3):** 0.232 m<sup>3</sup>

## Plan view Dimensions

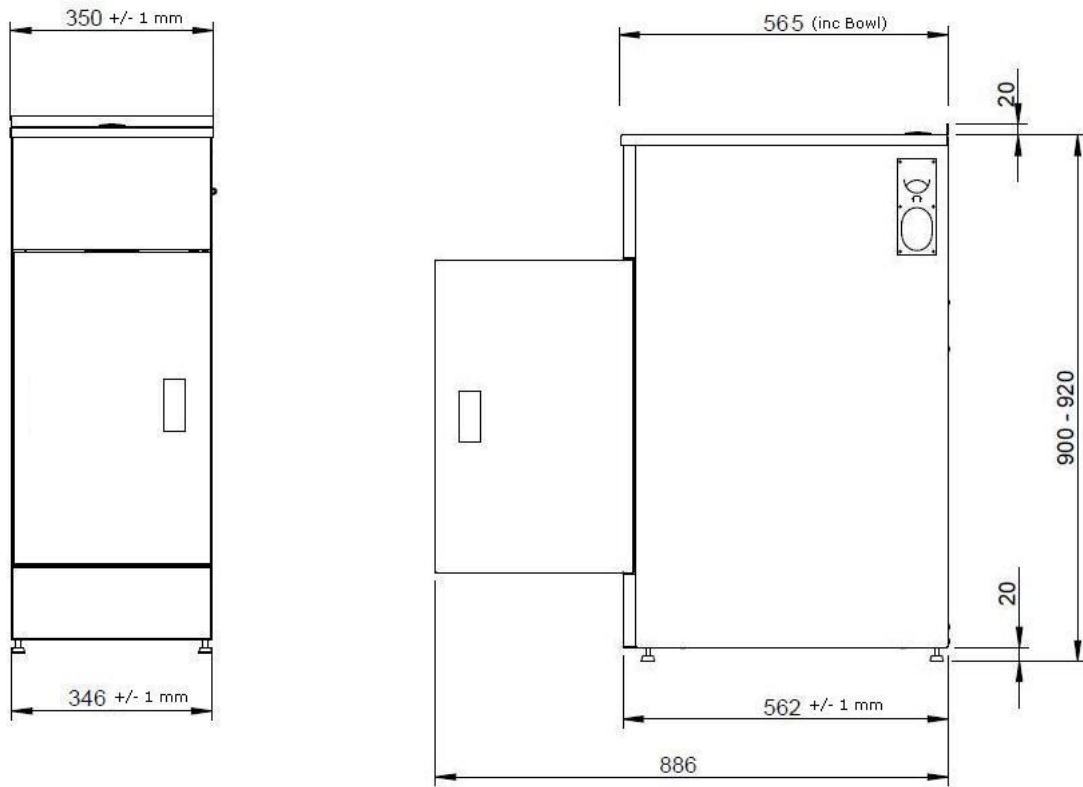

## Drawer and Bowl Dimensions

The tub detail to the top of the tub volume is 22 litres

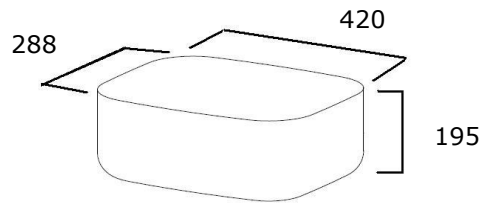

The detail to the bottom of the overflow volume is 17 litres

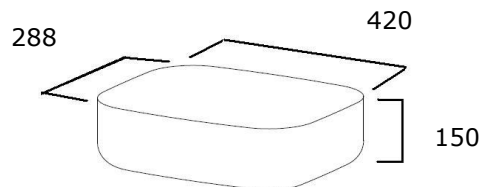

## Fit Out Detail Side View

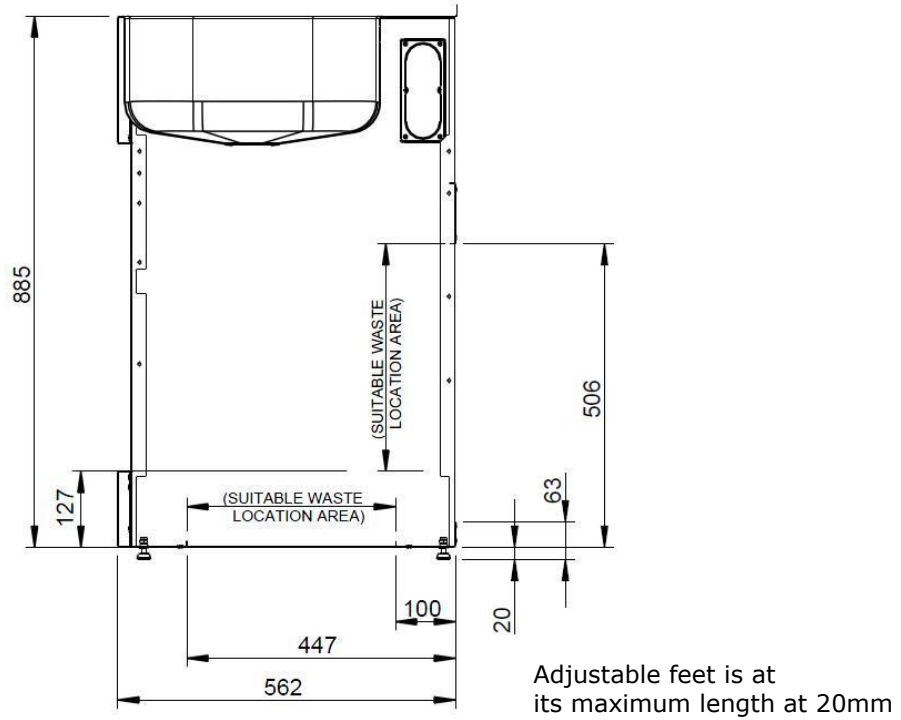

## Fit Out Detail Front View

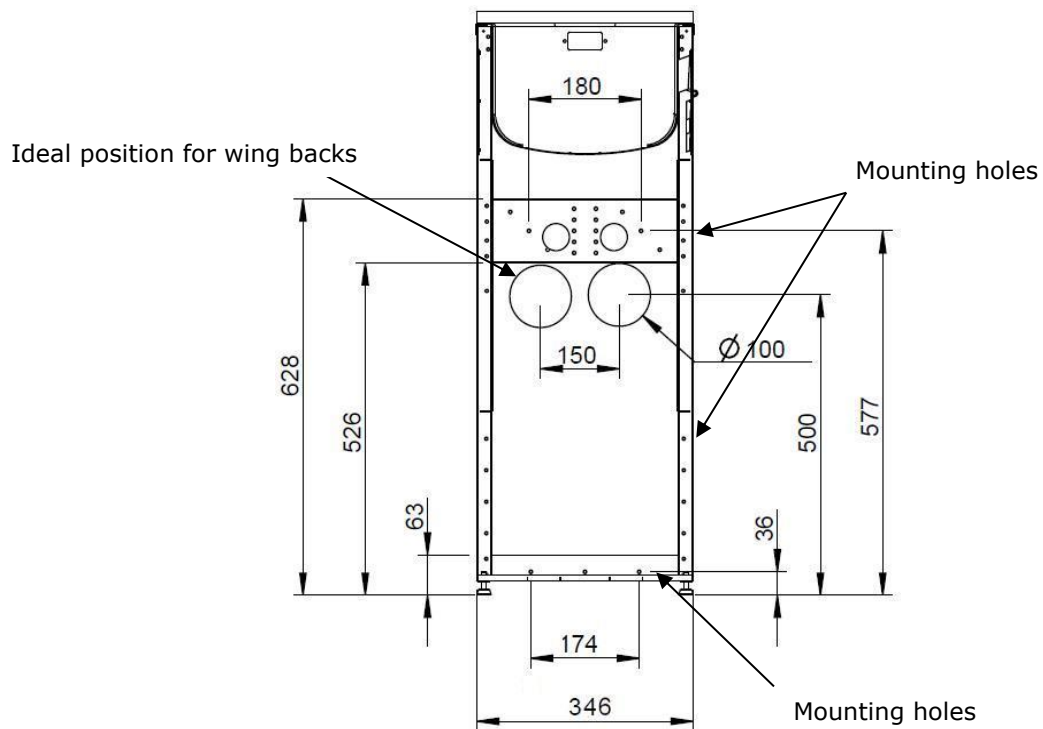

### New Zealand

Monaco Corporation Ltd  
 Telephone: (09) 415 6000  
 Facsimile: (09) 415 7400  
 Email: [enquiries@robinhood.co.nz](mailto:enquiries@robinhood.co.nz)  
[www.robinhood.co.nz](http://www.robinhood.co.nz)

### Australia

Shriro Australia Pty Ltd  
 ABN 28 002 386 129  
 Telephone: 1800 648 556  
 Facsimile: 1800 628 577  
 Email: [enquiries@robinhood.com.au](mailto:enquiries@robinhood.com.au)  
[www.robinhood.com.au](http://www.robinhood.com.au)